

TAG	X LOC	Y LOC
1	[0.15] 3.73	[0.58] 14.84
2	[0.15] 3.73	[2.04] 51.84
3	[0.19] 4.73	[0.13] 3.34
4	[0.19] 4.73	[2.49] 63.34
5	[0.44] 11.23	[0.38] 9.69
6	[0.50] 12.73	[2.24] 56.99
7	[1.25] 31.73	[2.24] 56.99
8	[1.31] 33.23	[0.38] 9.69
9	[1.56] 39.73	[0.13] 3.34
10	[1.56] 39.73	[2.49] 63.34
11	[1.60] 40.73	[0.58] 14.84
12	[1.60] 40.73	[2.04] 51.84
13	[0.38] 9.53	[1.31] 33.34
14	[1.38] 34.93	[1.31] 33.34
15	[0.88] 22.23	[0.23] 5.84
16	[0.88] 22.23	[1.31] 33.34

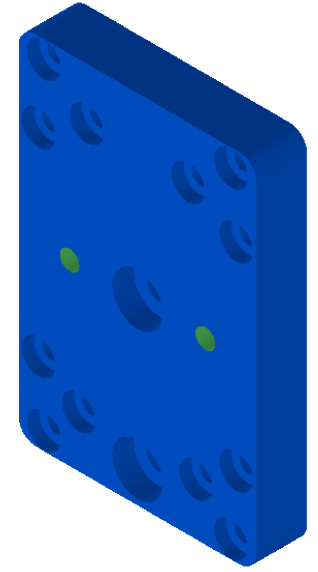
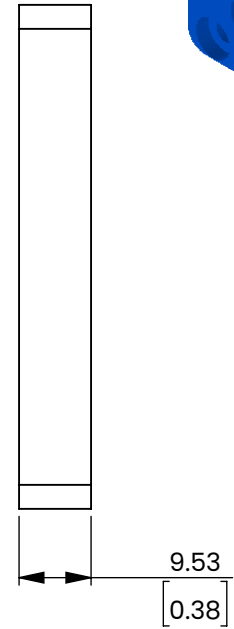
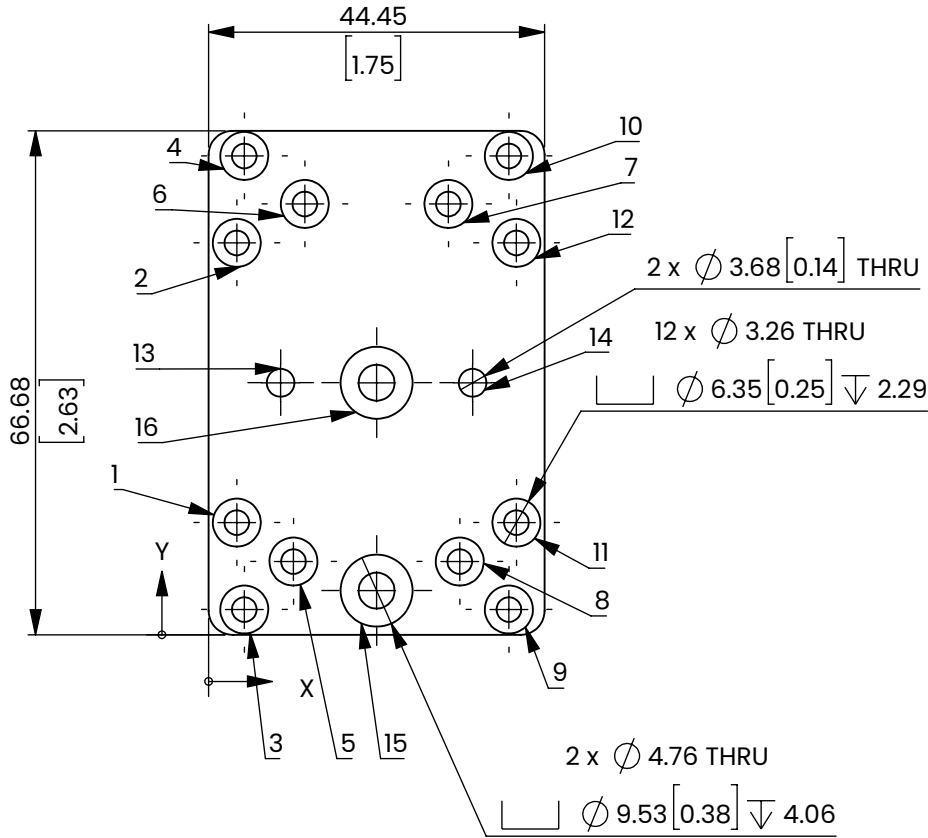

**Machine VISION DIRECT**

This item is sold and supported worldwide by Machine Vision Direct

For Quotes and Support: [Support@MachineVisionDirect.com](mailto:Support@MachineVisionDirect.com)

+1 (800) 834-5588 | [MachineVisionDirect.com](http://MachineVisionDirect.com)

This drawing is provided for reference only. It is not approved for manufacturing and the actual component can vary. We encourage that any discrepancies are reported to our CAD department at [CAD@MachineVisionDirect.com](mailto:CAD@MachineVisionDirect.com)

NAME	DATE
S. Shaikh	08/02/2023
DRAWN	CHECKED
PART NUMBER	REV
<b>AFSB-520XS-C-Dmic</b>	A
MANUFACTURER: Swivellink	
SCALE: 1:1	ALL DIMENSIONS ARE IN MILLIMETERS